

FRAISE À LAMER 3/4
FRÄSSTICHEL 3/4
COUNTERBORE ENDMILL 3/4

24013N-0.3

Version du
15.06.2020



Compatibilité outil / matière
Werkzeug / Werkstoffverträglichkeit
Tool / Material compatibility

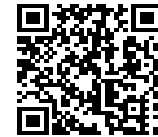

ESHOP / EZI CUT

- 1/3
- 2/3
- 3/3

Gruppe **N15**
Vc [m/min]

Matériau	Propriété	Code	Vc [m/min]	Compatibilité
ACIERS ALLIÉS ET NON ALLIÉS UNLEGIERTE STÄHLE NON-ALLOYED STEELS	Rm < 450 N/mm ²	1a		
	Rm 450 - 700 N/mm ²	1b		
	Rm 700 - 900 N/mm ²	1c		
	Rm < 1200 N/mm ²	1d		
ACIERS INOX ROSTFREIE STÄHLE STAINLESS STEELS	Rm < 650 N/mm ²	2a		
	Rm 650 - 950 N/mm ²	2b		
	Rm > 950 N/mm ²	2c		
ACIERS TREMPÉS STÄHLE GEHÄRTETE HARDENED STEELS	44 - 56 HRC	3a		
	57 - 67 HRC	3b		
MATÉRIAUX EXOTIQUES EXOTISCHE WERKSTOFFE EXOTIC MATERIALS	< 32 HRC	4a		
	> 32 HRC	4b		
GRAPHITE		5		
FONTES GUSS CAST IRON	< 32 HRC	6a		
	> 32 HRC	6b		
TITANE TITAN	Rm < 800 N/mm ²	7a		
	800 < Rm N/mm ²	7b		
ALLIAGES NICKEL NICKEL NICKEL ALLOYS	Rm < 1000 N/mm ²	8a		
	1000 < Rm N/mm ²	8b		
CUIVRE, LAITON, BRONZE KUPFER, MESSING, BRONZE COPPER, BRASS, BRONZE	Rm < 850 N/mm ²	9a	320	●
	850 < Rm N/mm ²	9b	200	●
ALUMINIUM	Si < 0.5%	10a	300	●
	0.5% < Si < 5%	10b	250	●
	Si > 5%	10c		●
MATIÈRES SYNTHÉTIQUES KUNSTSTOFFE SYNTHETIC MATERIALS	Thermoplast	11a		
	Duraplast	11b		
MATIÈRES COMPOSITES FASERVERST. MATERIALEN COMPOSITE MATERIALS	Fibre de verre	12a		
	Fibre de carbone	12b		
MÉTALX PRÉCIEUX EDELMETALLE PRECIOUS MATERIALS	Or • Gold	13a	320	●
	Platine	13b		

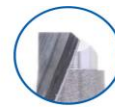

D (0/- 0.02)	0.3
d (h5)	6
L	33
h1	1
h3	
d3	
R	
e	
Z	1
Chanfrein	
K	
w° collision	12.3°